

# **PROGRAM**

---

## **Flow Dynamics**

**First International Conference on Flow Dynamics**

## **AFI/TFI-2004**

**Fourth International Symposium on Advanced Fluid Information /  
First International Symposium on Transdisciplinary Fluid Integration**

November 11-12, 2004

Sendai International Center, Sendai, Japan

# **First International Conference on Flow Dynamics**

## **Organized and Sponsored by**

The 21st Century COE program, "International COE of Flow Dynamics," Tohoku University, Japan

## **21st Century COE Program "International COE of Flow Dynamics" Members**

Shigenao Maruyama	Toshiyuki Takagi	Yasuaki Kohama
Taku Ohara	Shigeru Obayashi	Kazuhiro Nakahashi
Hideya Nishiyama	Satoyuki Kawano	Akihiro Sasoh
Keisuke Sawada	Hideaki Kobayashi	Keisuke Asai
Goro Masuya	Kazuyuki Tohji	Junichiro Mizusaki
Kaoru Maruta	Michio Tokuyama	Takatoshi Ito
Hiroaki Niitsuma	Toshiyuki Hashida	

## **Organizing Committee**

### **General Chair**

Shigenao Maruyama

### **Secretariat**

Akihiro Sasoh, Satoyuki Kawano, Takehiko Sato, Sachiko Shuto

### **COE Administrative Staff**

Masayoshi Ito, Nao Konohara, Yoshikatsu Kamata, Natsuko Hatakeyama, Aki Tanno

## **Conference Office**

21st Century COE Program Building, Institute of Fluid Science, Tohoku University

2-1-1 Katahira, Aoba, Sendai, 980-8577, Japan

Phone&Fax :+81-22-217-5301

E-mail: flowconf@nana.ifs.tohoku.ac.jp

# Fourth International Symposium on Advanced Fluid Information / First International Symposium on Transdisciplinary Fluid Integration

**Hosted by:** Institute of Fluid Science, Tohoku University, Japan

**Sponsored by:**

Tohoku University Foundation

Science Foundation for Fluid Mechanics and Instruments

Inoue Foundation for Science

**International Advisory Committee**

R. Adrian (USA)	P. H. Alfredsson (Sweden)	R. E. A. Arndt (USA)
R. W. Bilger (Australia)	C. E. Brennen (USA)	D. J. Economou (USA)
K. Hayashi (Japan)	H. Higuchi (USA)	J. A. C. Humphrey (USA)
T. Ikohagi (Japan)	O. Inoue (Japan)	K. Nanbu (Japan)
J. Periaux (France)	H. E. Stanley (USA)	M. Tokuyama (Japan)

**International Steering Committee**

T. Ikohagi (Japan), Chairperson	K. Fujii (Japan)	S. Fujikawa (Japan)
I. Fujishiro (Japan)	Y. Fukunishi (Japan)	T. Hasegawa (Japan)
N. Kasagi (Japan)	C. Kato (Japan)	G. Masuya (Japan)
Y. Matsumoto (Japan)	K. Nakahashi (Japan)	M. Nakano (Japan)
S. Nishio (Japan)	S. Obayashi (Japan)	K. Sawada (Japan)
T. Tanahashi (Japan)	Y. Tsuji (Japan)	Y. Tsujimoto (Japan)

**Organizing Committee**

S. Obayashi, AFI Chairperson	H. Kobayashi, TFI Chairperson	
A. Endou	T. Hayase	T. Ito
T. Kato	S. Kawano	Y. Kohama
K. Maruta	S. Maruyama	H. Nishiyama
T. Ohara	J. Qiu	S. Samukawa
A. Sasoh	T. Sato	A. Shirai
M. Sun	T. Takagi	T. Tokumasu
M. Tokuyama	T. Uchimoto	S. Yonemura

**Symposium Secretariat**

Prof. Shigeru Obayashi

AFI-2004 Secretariat, Institute of Fluid Science, Tohoku University,

Katahira 2-1-1, Aoba-ku, Sendai 980-8577, Japan

E-mail: [afi-2004@ifs.tohoku.ac.jp](mailto:afi-2004@ifs.tohoku.ac.jp)

## Plenary Lectures

### **TFI Plenary Lecture**

(9:10-10:10, 11 November, at “Tachibana”)

**Combined Heat, Air, Moisture, and Pollutants Transport in Building  
Environmental Systems  
Prof. Jianshun Zhang (Syracuse University, U.S.A.)**

### **AFI Plenary Lecture**

(13:00-14:00, 11 November, at “Tachibana”)

**Intelligent Systems: Shaping the Future of Aeronautics and Space  
Exploration  
Dr. Kalmanje KrishnaKumar (NASA Ames Research Center, U.S.A.)**

### **COE Plenary Lecture**

(9:00-10:00, 12 November, at “Hagi”)

**Dynamic Activity of Water on the Nature Technology  
Dr. Hideki Ishida (INAX Corporation, Tohoku University, Japan)**

## General Sessions

### **First International Conference on Flow Dynamics**

#### **Organized Sessions:**

OS1: Research and Development of Japan Made High Performance Jet Plane

OS2: Nano-mega Ground Effect and Applications

OS3: Functional Fluids Flow Dynamics in Interactive Systems

OS4: Force Generation through Shock Wave Dynamics

OS5: Alleviation of Shock-induced Hazards

OS6: Planetary Entry Flow Physics

OS7: Water Dynamics

OS8-A: Young Birds Hatchery Session on Flow Dynamics

OS8-B: International Students/Young Birds Session on Flow Dynamics

### **Fourth International Symposium on Advanced Fluid Information / First International Symposium on Transdisciplinary Fluid Integration**

#### **Mini-Symposia:**

MS1: Fluid Informatics in Bio-Fluid Systems

MS2: Fusion of Biotechnology and Nanotechnology

MS3: Advanced Fluid Information and Aerospace Applications

MS4: Collaborative Visualization and Volume Communication

MS5: 5th Japan-Korea Seminar on Combustion and Heat Transfer & CERC Workshop

MS6: Smart Material, Structural and Fluid Systems

MS7: Advanced Fluid Information for Controlling Flows

## **General Information**

### **Registration:**

The conference registration desk is located at **Main Hall, 2nd floor**.

**Thursday, 11 November, 8:30–17:00 hrs**

**Friday, 12 November, 8:30–17:00 hrs**

### **Banquet:** (at Sakura 1)

**Thursday, 11 November, 19:00–21:00 hrs**

### **Exhibition:** (at Sakura 2)

All conference attendees may view the exhibition for free. Exhibition hours will be:

**Thursday, 11 November, 15:00–21:00 hrs**

**Friday, 12 November, 9:00–17:00 hrs**

### **Internet access corner:** (Sakura 2)

All conference attendees may use internet for free. Free Ethernet access will be possible at Sakura 2 during the conference. Standard wired hubs (with RJ45 sockets) will be provided for networking.

Internet corner will be opened at:

**Thursday, 11 November, 15:00–21:00 hrs**

**Friday, 12 November, 9:00–17:00 hrs**

### **Coffee service:**

Coffee service is prepared at **3rd floor**, in front of the stairs.

# Floor Plan of Sendai International Center

1st floor (Room 1, Room 2)

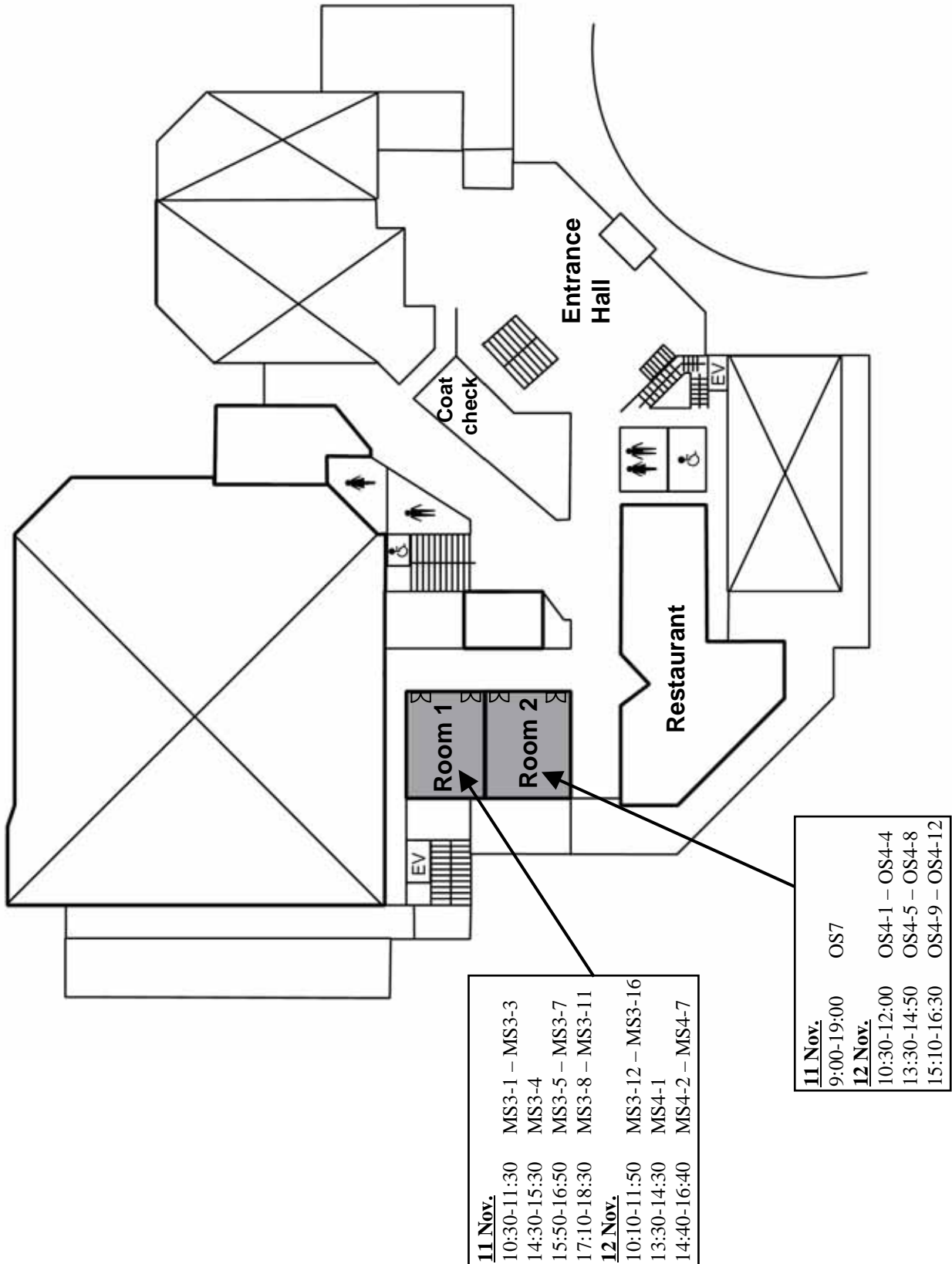

## 2nd floor (Sakura, Tachibana, Hagi, Room 4, Room 5)

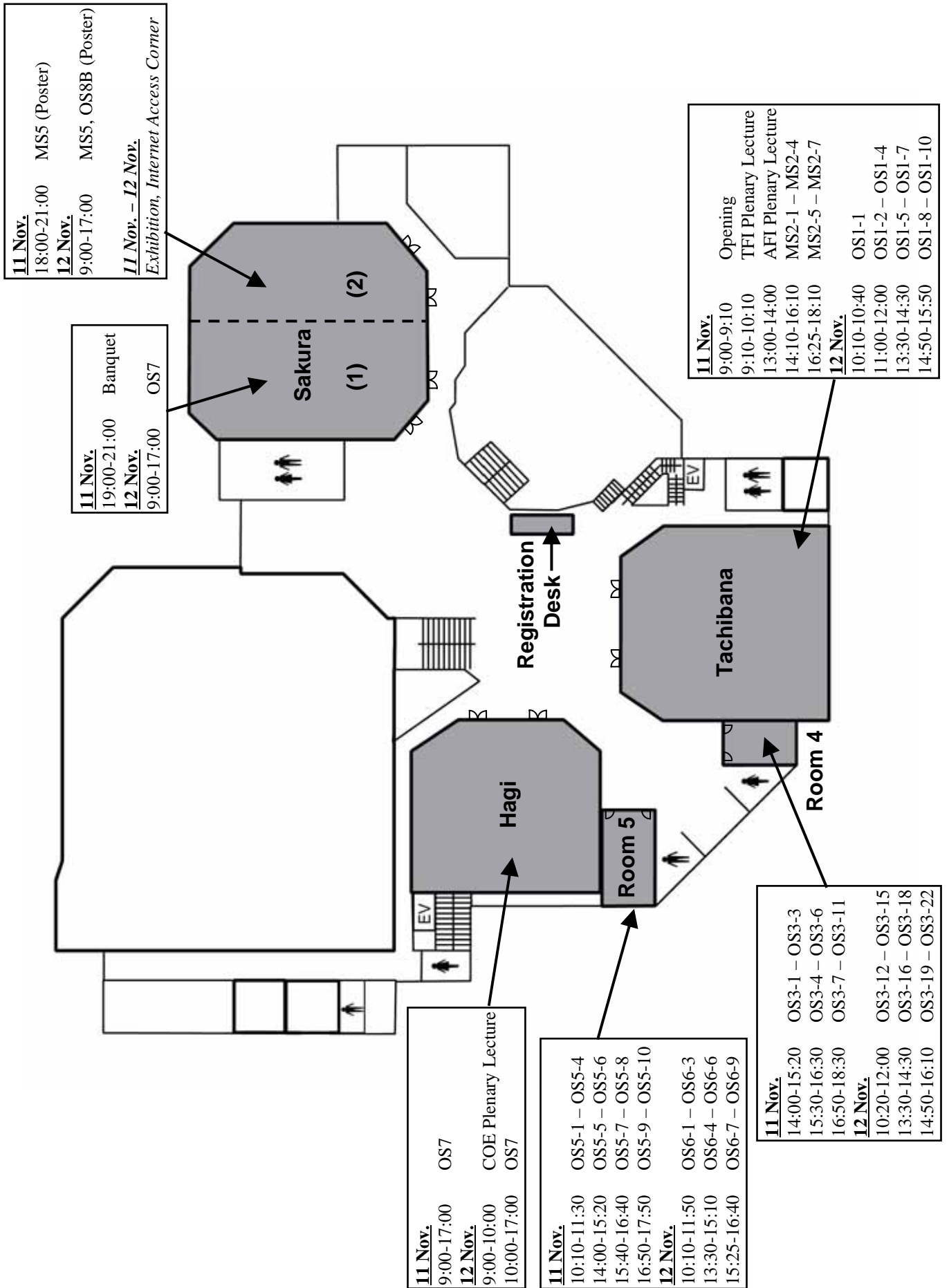

### 3rd floor (Shirakashi, Room 6, Room 7, Room 8)

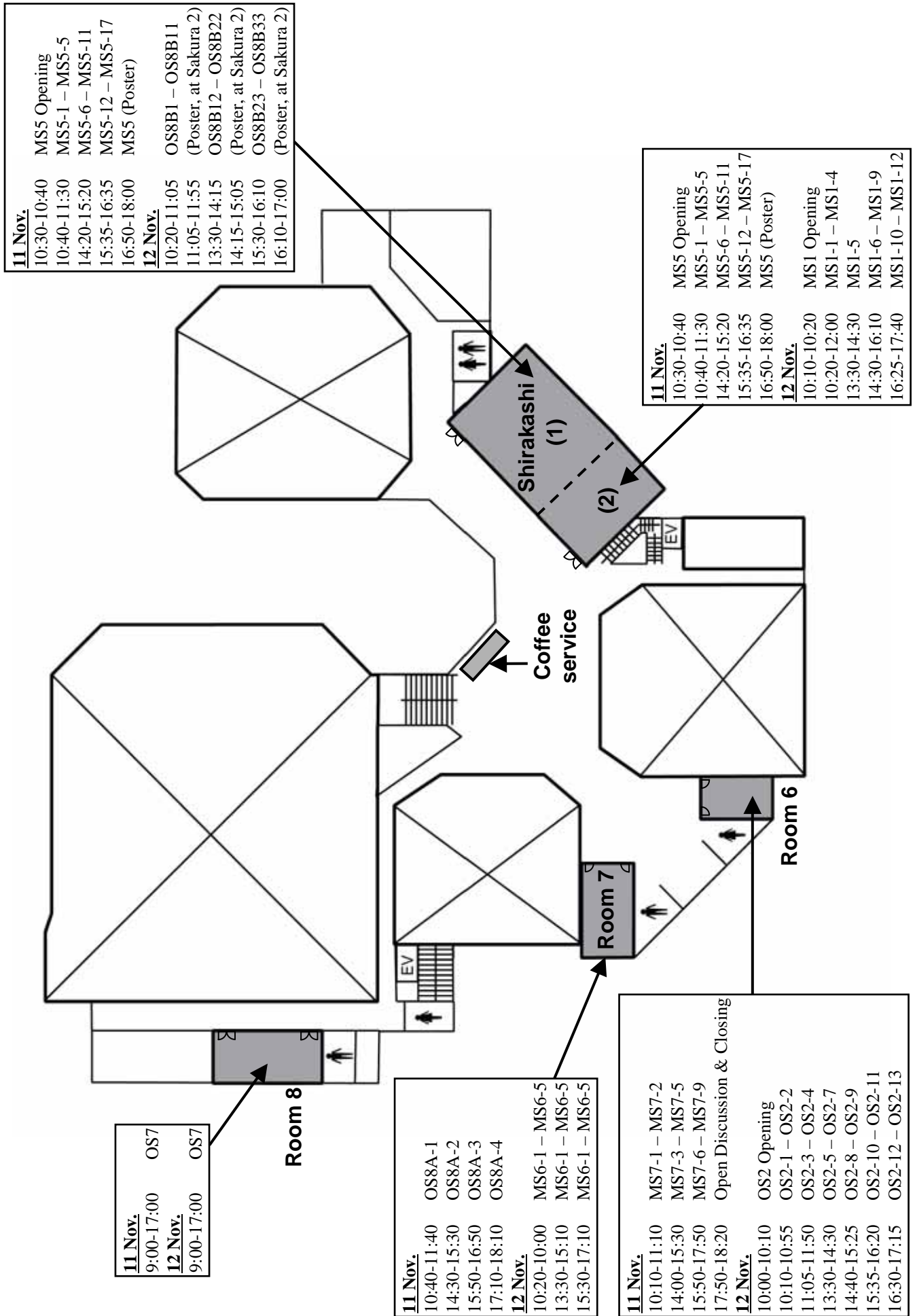

**Thursday, 11 November, 2004**

	Tachibana	Room1	Room4	Room5	Room6	Room7
9:00	9:00 Opening	(9:00-9:10 Opening, at "Tachibana")				
9:10-10:10	TFI Plenary Lecture J.S.Zhang	(9:10-10:10 TFI Plenary Lecture, at "Tachibana")				
10:00					10:10 MS7-1 J.-P.Bonnet (Invited)	
11:00		10:30 MS3-1 W.Yamazaki		10:20 OS5-1 H.Taniguchi (Invited)		10:40 OS8A-1 M.lima (Invited)
		10:50 MS3-2 S.Watanabe		10:40 OS5-2 T.Furukawa		
		11:10 MS3-3 H.-H.Shi		11:00 OS5-3 Y.Miura	11:10 MS7-2	
				11:20 OS5-4 S.Oshiba	J.Ausseur	
12:00	(Lunch)					
13:00	13:00-14:00 AFI Plenary Lecture K.KrishnaKumar	(13:00-14:00 AFI Plenary Lecture, at "Tachibana")				
14:00			14:00 OS3-1 O.P.Solonenko (Invited)	14:00 OS5-5 M.Yoshida (Invited)	14:00 MS7-3 A.Nishizawa	
15:00	14:10 MS2-1 I.Yamashita 14:20 MS2-2 J.E.Johnson (Invited)	14:30 MS3-4 A.J.Meade (Invited)	14:40 OS3-2 M.Tanaka	14:40 OS5-6 E.Zaretsky (Invited)	14:30 MS7-4 K.Fukagata	14:30 OS8A-2 T.Tajikawa (Invited)
	15:00 MS2-3 T.Urisu		15:00 OS3-3 Y.Tanaka		15:00 MS7-5 S.Izawa	
16:00	15:35 MS2-4 T.Ichiki		15:30 OS3-4 M.Shigeta	15:40 OS5-7 J.J.Alonso (Invited)		
	15:50 MS3-5 J.-H.Yoo	15:50 OS3-5 M.Okubo		15:50 MS7-6 T.Hayase	15:50 OS8A-3 K.Yokoi (Invited)	
	16:10 MS3-6 I.G.Lim	16:10 OS3-6 T.Sato		16:20 MS7-7 H.Higuchi		
17:00	16:25 MS2-5 T.Aoyagi	16:30 MS3-7 J.-Y.Kim		16:20 OS5-8 Y.Makino		
17:00	17:00 MS2-6 S.Yoshii		16:50 OS3-7 K.Yoshida	16:50 OS5-9 K.Kusunose (Invited)	16:50 MS7-8 H.Sato	
	17:10 MS3-8 Y.Ooba	17:10 OS3-8 M.Shams			17:20 MS7-9 R.E.A.Arndt	17:10 OS8A-4 M.Uchiumi (Invited)
18:00	17:35 MS2-7 S.Samukawa	17:30 MS3-9 T.Ozawa	17:30 OS3-9 D.Sivakumar	17:30 OS5-10 Y.Goto		
		17:50 MS3-10 G.Hashimoto	17:50 OS3-10 X.R.Zhang		17:50 MS7 Open Discussion and Closing	
		18:10 MS3-11 J.Imamura	18:10 OS3-11 H.Takana			
19:00						
20:00	(19:00- Banquet, at "Sakura 1")					
21:00						

Shirakashi 1	Shirakashi 2	Sakura 1	Sakura 2	Hagi	Room2	Room8	
(9:00-9:10 Opening, at "Tachibana")				OS7: Water Dynamics (refer to separate program)	OS7: Water Dynamics (refer to separate program)	OS7: Water Dynamics (refer to separate program)	9:00
(9:10-10:10 TFI Plenaery Lecture, at "Tachibana")							10:00
10:30 MS5 Opening							
10:40 MS5-1 C.B.Lee (Invited)							
10:50 MS5-2 H.Y.Kim							
11:00 MS5-3 N.I.Kim							11:00
11:10 MS5-4 C.Y.Lee							
11:20 MS5-5 K.Takita							
(Lunch)							12:00
(13:00-14:00 AFI Plenaery Lecture, at "Tachibana")							13:00
14:20 MS5-6 S.In							
14:30 MS5-7 W.-H.Park							
14:40 MS5-8 W.Yang							
14:50 MS5-9 H.Kobayashi							
15:00 MS5-10 J.Kim			15:00 Exhibition				15:00
15:10 MS5-11 Y.Nunome							
15:35 MS5-12 W.Kang							
15:45 MS5-13 V.K.Baev							
15:55 MS5-14 S.Kadowaki							16:00
16:05 MS5-15 W.Lee							
16:15 MS5-16 T.Hasegawa							
16:25 MS5-17 H.Kobayashi							
16:50 MS5 Poster Presentation							17:00
			18:00 MS5 Poster Presentation, Exhibition				18:00
(19:00- Banquet, at "Sakura 1")		19:00 Banquet					19:00
							20:00
							21:00

Friday, 12 November, 2004

	Tachibana	Room1	Room2	Room4	Room5	Room6
9:00	(9:00-10:00 COE Plenary Lecture, in "Hagi")					
10:00						10:00 OS2 Opening
	10:10 OS1-1 D.-H.Lee (Invited)	10:10 MS3-12 L.Parussini		10:20 OS3-12 J.D.Carlson (Invited)	10:10 OS6-1 C.Park (Invited)	10:10 OS2-1 E.Bertran (Invited)
		10:30 MS3-13 S.Pieri	10:30 OS4-1 N.Chinzei (Invited)			10:40 OS2-2 T.Takeno
11:00		10:50 MS3-14 H.-J.Kim				
	11:00 OS1-2 K.Kamo	11:10 MS3-15 M.Kanazaki	11:00 OS4-2 T.Kouchi	11:00 OS3-13 H.Yamaguchi	11:00 OS6-2 K.Fujita	11:05 OS2-3 J.Fontaine
	11:20 OS1-3 A.Nishizawa	11:30 MS3-16 K.Chiba	11:20 OS4-3 T.Kanda	11:20 OS3-14 H.Hakogi	11:25 OS6-3 Y.Miura	11:35 OS2-4 T.Abe
	11:40 OS1-4 S.Iwase		11:40 OS4-4 E.Kitamura	11:40 OS3-15 S.Sudo		
12:00	(Lunch)					
13:00						
14:00	13:30 OS1-5 S.Tatsumi	13:30 MS4-1 H.-C.Hege (Invited)	13:30 OS4-5 T.Ohtani	13:30 OS3-16 M.Motozawa	13:30 OS6-4 G.Candler (Invited)	13:30 OS2-5 Y.Kohama
	13:50 OS1-6 D.-H.Yoon		13:50 OS4-6 Y.Xilong	13:50 OS3-17 K.Shimada		14:00 OS2-6 Y.Takahashi
	14:10 OS1-7 A.Inasawa		14:10 OS4-7 K.Watanabe	14:10 OS3-18 Y.Ido		14:15 OS2-7 T.Ishizuka
			14:30 OS4-8 K.Mori		14:20 OS6-5 M.Matsui	
15:00	14:50 OS1-8 Y.Kohama	14:40 MS4-2 N.Kukimoto		14:50 OS3-19 M.Nakano	14:45 OS6-6 T.Aochi	14:40 OS2-8 S.Zhang (Invited)
	15:10 OS1-9 K.Sakurai	15:00 MS4-3 Y.Takeshima	15:10 OS4-9 S.Obata	15:10 OS3-20 T.Tshukiji		15:10 OS2-9 D.Torii
	15:30 OS1-10 K.Nishide	15:20 MS4-4 N.Sakamoto	15:30 OS4-10 H.Nakamura	15:30 OS3-21 T.Narumi	15:25 OS6-7 K.Murakami	15:35 OS2-10 N.Ohtake (Invited)
16:00		15:40 MS4-5 J.Nonaka	15:50 OS4-11 H.Sugiyama	15:50 OS3-22 Y.Matsumura	15:50 OS6-8 K.Suzuki	16:05 OS2-11 T.Takagi
		16:00 MS4-6 M.Watanabe	16:10 OS4-12 G.Masuya		16:15 OS6-9 T.Abe	
		16:20 MS4-7 I.Fujishiro			16:40 OS6 Closing	16:30 OS2-12 T.Ohana (Invited)
17:00	X					17:00 OS2-13 I.Nakamori
						17:15 OS2 Closing
18:00	X					
19:00						

